



Electronic
Safe
Solutions

ZENITH
by Elsafe®

FEATURES:

- : Industry-leading audit trail
- : Audit trail with in-room print-out option
- : Flash memory
- : ADA compliant telephone-style keypad
- : 4-digit guest code
- : LED display for clear visible numbers
- : Backlit keypad
- : Push button to close door
- : Powered with 5 LR6/AA batteries
- : Easy outside battery change
- : Spring loaded door
- : Inside shelf
- : Laptop compatible up to 17"
- : Serviced by Safelink or PinKey PLUS
- : Support IR communication
- : Anti-tamper labyrinth
- : 2*18mm solid steel bolt locking mechanism
- : Inside carpet

Zenith Floor safe by Elsafe

The Zenith Floor safe is a spacious floor-mounted safe that allows you to secure larger items, such as briefcases, laptops in its bag, and electronic equipment.

Based on the same product platform as Zenith by Elsafe, the floor safe is equipped with the same electronics and service device tools. Thus making it available for a mixed installation with other Zenith models by Elsafe.

DROP SAFE

In addition to the standard version of Zenith Floor safe, we also offer a Drop Safe which includes a "letterbox" on top. This enables a convenient way of adding important documents or similar in the safe without having to open it each time.



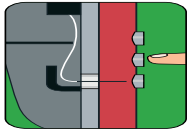

ANTI-TAMPER LABYRINTHS OFFER HIGHER PROTECTION AGAINST MANIPULATION.

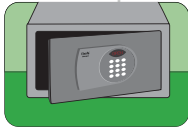

SPRING-LOADED DOOR INDICATES IF THE DOOR IS IN OPEN OR CLOSED POSITION, AVOIDING GUESTS LEAVING THE SAFE OPEN UNINTENTIONALLY.

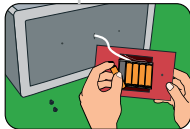

QUICK BATTERY CHANGE WITHOUT HAVING TO OPEN THE SAFE. IT SAVES TIME AND MONEY.

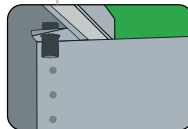

SOLID ONE-PIECE CONSTRUCTION ENHANCES SECURITY AND ELIMINATES ACCESS TO VITAL COMPONENTS.

Measurements		Zenith Floor Safe ZDFL / ZDFD
Outside H/W/D Incl. keyboard	mm in	536/355/457 21 ^{1/8} /14 ^{1/8}
Inside H/W/D	mm in	500/349/371 19 ^{11/16} /13 ^{3/4} /14 ^{5/8}
Door dimensions H x W	mm in	460/226 18 ^{1/8} /8 ^{15/16}
Internal volume	litres cu ft	66 2,33
Weight	kg lb	36,2 79,8
Drop safe slope	mm in	170 x 9,5 6,69 x 0,37

H/W/D: Height/Width/Depth

- : Override: SafeLink and PinKey PLUS
- : Steel thickness: Door: 8 mm / Body: 3 mm
- : Fastening method: Bottom: Fastening Plate 3mm, 4 bolts

SafeLink:
Elsafe SafeLink helps you set up and service your Zenith safe in seconds. With Zenith by Elsafe you can even print a detailed 500-event log from the safe memory.



PinKey PLUS:
Elsafe PinKey PLUS is a compact and powerful electronic PIN-code protected, non-resident master key to securely override Elsafe in-room safes. This allows for easy day-to-day safe operations.



Additional Zenith safe models:
Zenith by Elsafe is also available in the following models:



Drawer Safe



In-wall Safe

Drop safe:
With the drop safe option, the inside has a small slope in the ceiling of the safe.



Contact us:



ASSA ABLOY

Stay Smart