



Electronic
Safe
Solutions



ZENITH
by Elsafe®

FEATURES

- : Industry-leading audit trail
- : Audit trail with in-room print-out option
- : Flash memory
- : ADA compliant telephone-style keypad
- : 4-digit guest code
- : LED display for clear visible numbers
- : Backlit keypad
- : Push button to close door
- : Powered with 5 LR6/AA batteries
- : Easy outside battery change
- : Spring loaded door
- : 3 models (27/43/Wide)
- : Laptop compatible up to 17" (for Wide)
- : Serviced by Safelink or PinKey PLUS
- : Support IR communication
- : Anti-tamper labyrinth
- : 18mm solid steel bolt locking mechanism
- : Inside carpet
- : Internal power outlet option (UK/US/EURO)
- : Inside light
- : Optional tamper switch
- : Triangular support to locking bolt for mechanism enforcement

CODE ACT

- : Rental safe option where guest must pay to use the safe. The safe is made available through an 8 digit activation code. (No additional hardware needed, but depends on a PC-based administration system)

Zenith by Elsafe

Stay Safe

The choice of in-room electronic safes becomes easy when you can choose Zenith by Elsafe to secure your guests' belongings.

Zenith is advanced and economical security, with the industry's leading audit trail system that allows you to print out comprehensive reports on all safe activities.

Zenith by Elsafe is available in many sizes and models to complement your hotel room regardless of style and need.



Specifications

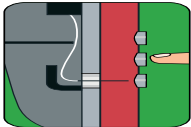

Anti-tamper labyrinths offer higher protection against manipulation.



Spring-loaded door indicates if the door is in open or closed position, avoiding guests leaving the safe open unintentionally.



Quick battery change without having to open the safe. It saves time and money.

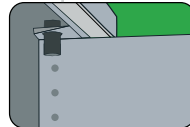

Solid one-piece construction enhances security and eliminates access to vital components.

Sizes 27 / 43 are external depth

*Measurements		Zenith 27	Zenith 43	Zenith Wide
External dimensions (h/w/d) incl. keypad	mm	191/354/270	191/354/432	191/460/417
	inches	7 ³³ / ₆₄ /13 ¹⁵ / ₁₆ /10 ⁴¹ / ₆₄	7 ³³ / ₆₄ /13 ¹⁵ / ₁₆ /17	7 ³³ / ₆₄ /18 ¹ / ₈ /16 ²⁷ / ₆₄
Internal dimensions (h/w/d)	mm	188/351/200	188/351/361	188/457/345
	inches	7 ³ / ₈ /13 ¹³ / ₁₆ /7 ⁷ / ₈	7 ³ / ₈ /13 ¹³ / ₁₆ /17 ⁷ / ₃₂	7 ³ / ₈ /18 ¹³ / ₁₆ /19 ³ / ₃₂
Door dimensions (h/w)	mm	140/295		140/400
	inches	5 ¹ / ₂ /11 ⁵ / ₈		5 ¹ / ₂ /15 ³ / ₄
Internal volume	liters	13	24	31,5
	cu ft	0,46	0,84	1,11
Weight	kg	7,8	10	12
	lb	16,8	21,6	26,5

H/W/D: Height/width/depth

- : Override: Safelink and PinKey PLUS
- : Steel thickness (27/43): Door: 4 mm / Frame-Backwall: 2 mm / Body: 1,5 mm
- : Steel thickness (Wide): Door: 5 mm / Frame-Backwall: 2 mm / Body: 1,5 mm
- : Fastening method: Backwall: 3 holes / Bottom: 4 holes

SafeLink:

Elsafe SafeLink helps you set up and service your Zenith safe in seconds. With Zenith by Elsafe you can even print a detailed 500-event log from the safe memory.



PinKey PLUS:

Elsafe PinKey PLUS is a compact and powerful electronic PIN-code protected, non-resident master key to securely override Elsafe in-room safes. This allows for easy day-to-day safe operations.



Outlets:

Optional internal power outlet available on Zenith 27, 43 and Wide (EURO, US and UK).



Contact us:



ASSA ABLOY

Stay Smart

ASSA ABLOY, the global leader in door opening solutions

VingCard Elsafe | info@vingcardelsafe.com | www.vingcardelsafe.com
Provider of: VingCard Locks & Systems | Elsafe Safes | Orion EMS | PolarBar Minibars

Specifications may change without notice | Note: Image colors in this brochure may differ from actual colors
Our products, including maintenance and support, are only available when purchased exclusively through authorized partners as listed under "Local Offices" at www.vingcardelsafe.com.